

ITCB & ITCB-HV SINGLE/TWIN SERIES

DAILY CLEANING INSTRUCTIONS

AIRPOT

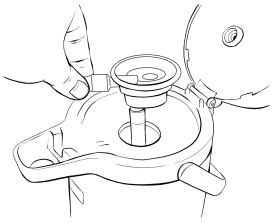

STEP 1

Open the airpot by pressing the buttons located on either side of the nozzle and lifting. Remove the pump tube assembly.

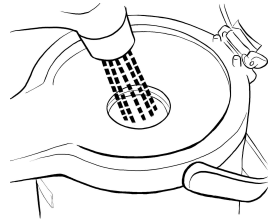

STEP 2

Thoroughly rinse the entire server.

TF SERVER

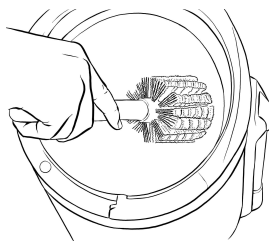

STEP 1

Remove the lid, fill server with cleaning solution and thoroughly clean the inside of server.

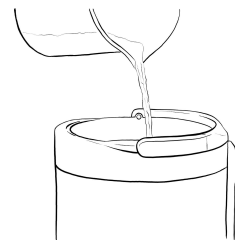

STEP 2

Rinse server thoroughly using fresh water rinse.

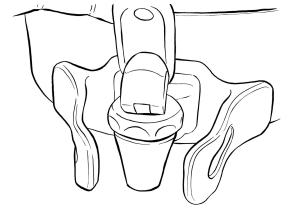

STEP 3

Fully fill server with sanitizing solution for 5 minutes then drain through fully open faucet.

BREWER

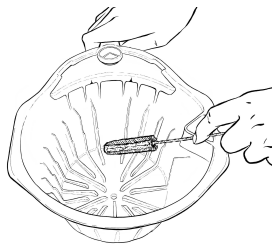

STEP 1

Once a day, clean and sanitize the brew funnels, funnel tips and screen assemblies.

TEA RESERVOIR

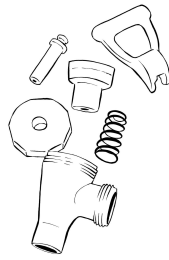

STEP 1

Once a day, turn the faucet in a counterclockwise direction and remove the faucet from the dispenser. Unscrew the faucet cap from the faucet body and disassemble all faucet parts.

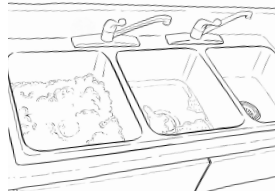

STEP 2

Transfer these parts to a three compartment sink for cleaning. Fill the first sink with a soap solution using a mild detergent, the second sink is used for clean rinse, and the third sink with a sanitizer solution (75°F warm chlorine solution of at least 50-100 ppm).

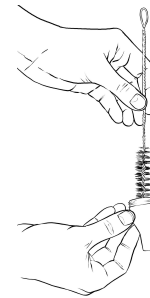

STEP 3

Use a bristle brush (BOM #00674.0000) to thoroughly scrub the faucet body.

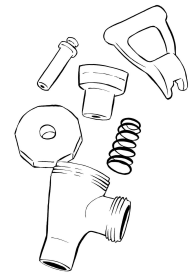

STEP 4

Allow the parts to soak in a sanitizer solution for a minimum of ten minutes. Remove the faucet parts from the sanitizer solution and rinse thoroughly. Allow parts to air dry over night.



STEP 6

Thoroughly clean the entire inside surface of the dispenser and the faucet shank using a small brush (BOM #00674.0000) mild detergent and water solution. Thoroughly rinse the dispenser with clean water.



STEP 7

Prepare a sanitizer solution in a clean bucket (1/4 gallon). Use a commercial sanitizer that has 50-100 ppm of available chlorine with a concentration level of at least 3% available chlorine (KAY-5 Sanitizer). Follow the mixing instructions to ensure 100 ppm of available chlorine.

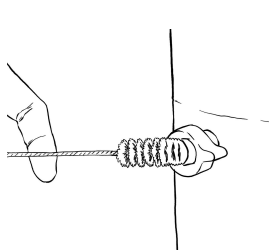

STEP 8

Pour a small amount of sanitizer solution into the dispenser. Use a bristle brush (BOM #00674.0000) to clean all the way through the faucet shank. Repeat several times.



STEP 9

Thoroughly rinse the dispenser with clean water. Allow the dispenser to air dry over night.



STEP 10

Assemble the faucet components and attach the faucet to the dispenser turning clockwise.

DO NOT KEEP BREWED BEVERAGES OVERNIGHT

ITCB

WEEKLY CLEANING INSTRUCTIONS

BREWER

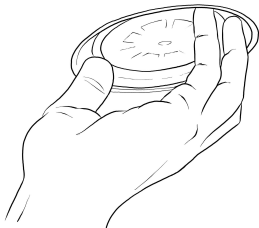

STEP 1

Remove and thoroughly rinse the sprayhead. The holes must be open and clear of any mineral deposits.

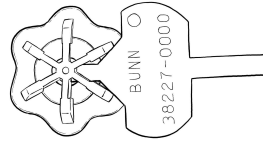

ALT.: STEP 1

If brewer has plastic high lime sprayhead: Remove the sprayhead. Use the sprayhead cleaning tool as shown.

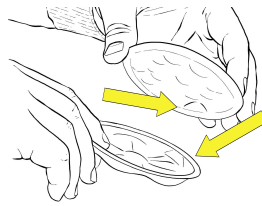

ALT.: STEP 1a

If brewer has large sprayhead: Remove the gasket to separate the two halves. Clean and sanitize all parts. Verify all the holes are open. To reassemble sprayhead, align the dimples as shown.

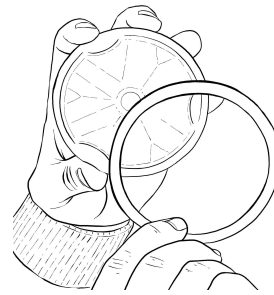

STEP 1b

Install gasket around the assembled sprayhead. Reinstall sprayhead on brewer.

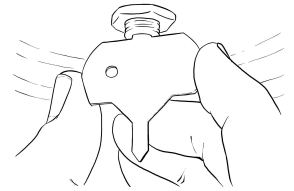

STEP 2

Use the long end of sprayhead cleaning tool to clean the sprayhead outlet fitting. Reinstall the sprayhead.

TEA RESERVOIR



STEP 1

Once a week, fill the dispenser with a chlorine solution (75°F warm chlorine solution of at least 50-100 ppm).

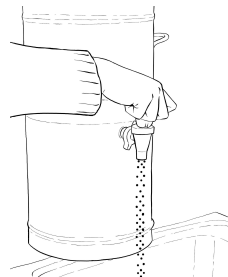

STEP 2

Draw a small amount (2 oz.) of presoak through the faucet making contact with the faucet components. Allow the dispenser to soak over night. The next morning, perform the daily cleaning procedures on the faucet and dispenser.

TF SERVER

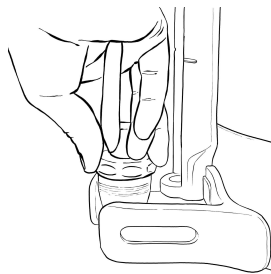

STEP 1

Remove the faucet handle/stem assembly by unscrewing the faucet nut just behind the faucet handle.

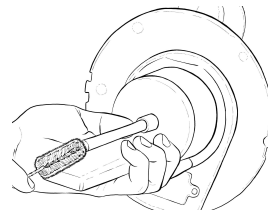

STEP 2

Use cleaning brush supplied with the server to thoroughly clean the fill tube of the lid assembly and the faucet spout. Wash the entire outside surface of the lid assembly with a mild detergent and water solution and rinse with hot water. Do not submerge.

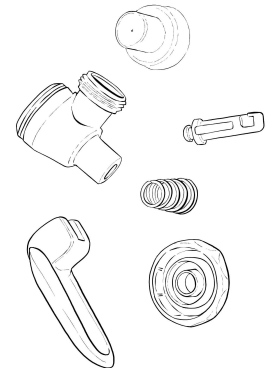

STEP 3

Disassemble the faucet/stem assembly. Thoroughly wash all faucet parts, drip tray and cover in a mild detergent and water solution. Rinse the parts in hot water. Sanitize the parts for five minutes, then air dry completely.

MONTHLY CLEANING INSTRUCTIONS

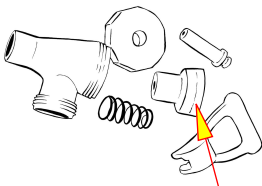

STEP 1

Once a month, replace the faucet seat cup (B.O.M. #00600.0000). Discard the old seat cup.



STEP 2

The faucet assembly (B.O.M. #03260.0001) can be ordered for replacement.

NOTE: Thoroughly cleaning the lid assembly fins will prevent inaccurate level readings.

DO NOT KEEP BREWED BEVERAGES OVERNIGHT